

CERTIFIED LAND CORNER RECORDATION

DESCRIPTION OF CORNER EVIDENCE FOUND, AND ORIGINAL RECORD (if known)

LOCATION

No evidence of corner monument found, obliterated corner.

$\frac{1}{4}$ S.20
 $\frac{1}{4}$ S.29

Corner re-established by tie from Union Pacific Railroad plans (Drawing No. 20699).

T.14N., R.60W.
6th P.M.

DESCRIPTION OF MONUMENT AND ACCESSORIES ESTABLISHED TO PERPETUATE THE ORIGINAL LOCATION OF THIS CORNER:

Set $1\frac{1}{2}$ " dia. x 30" long galv. iron pipe with brass cap for corner.
A $5/8$ " dia. x 24" long rebar with Surv KAP stamped "CORNER" bears N $89^{\circ}43'45"$ W, 40.00 feet distant.
Basis of bearing by solar observation.

SKETCH, WITH COURSE AND DISTANCE TO ADJACENT CORNER IF DETERMINED IN THIS SURVEY.
(May Sketch or Paste Reproduction on Reverse Side.)

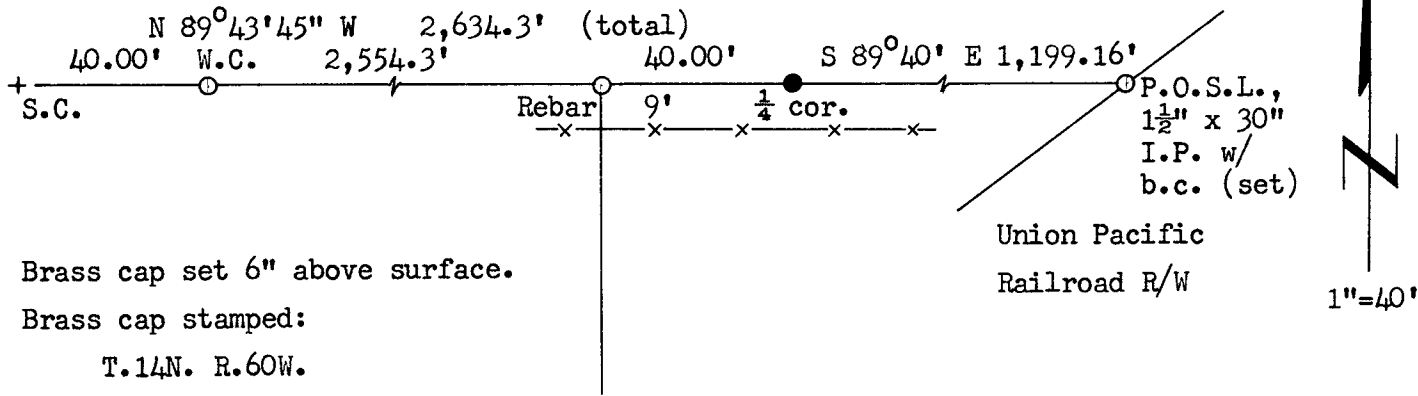

Brass cap set 6" above surface.

Brass cap stamped:

T.14N. R.60W.

$\frac{1}{4}$ S.20
 $\frac{1}{4}$ S.29

LS 519 1972

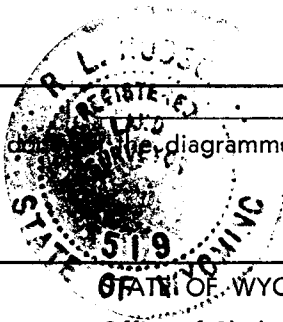

R.L. Hudson certify that I have carefully performed or reviewed the work on the diagrammed corner as reported on this recordation form and approve the same.

R.L. Hudson Wyoming L.S. No. 519
Signature of Surveyor Registration No.

STATE OF WYOMING,
Office of Clerk and Recorder,
County of Laramie

This "corner record" was filed for record on the 12th day of May, 1972, was noted on the cross-index plat and is assigned page No. 14-60, in book No. 519.

Jolly B. Hillman AW
County Official

Cross Index No. _____	T. _____	R. _____	Mer. _____
_____	T. _____	R. _____	Mer. _____
_____	T. _____	R. _____	Mer. _____
_____	T. _____	R. _____	Mer. _____
_____	T. _____	R. _____	Mer. _____
_____	T. _____	R. _____	Mer. _____
_____	T. _____	R. _____	Mer. _____

The State of Wyoming }
County of Lincoln } SS

This instrument was filed for record
at 11:44 o'clock A.M. on the
12th day of May
A. D. 1972 and duly recorded in
Book on page

[Handwritten Signature]

County Clerk & Ex-Officio Register of Deeds
By _____, Deputy